

FLUSH FRAMES

F-18 (1mm) • F-16 (1.3mm) • F-14 (1.7mm) • F-12 (2.5mm) • FS-16 (1.3mm) • FN-18 (1mm) • FN-16 (1.3mm) • FN-14 (1.7mm) • FE-16 (1.3mm) • FE-14 (1.7mm) • MU-18 (1mm) • MU-16 (1.3mm)

Steelcraft F, FE, FN, FS and MU series frames are designed for common walls such as wood stud, steel stud and masonry. MU18 and 16 gage only frames are available in 18 & 16 gage, cold-rolled steel (CRS) or A60 hot-dipped galvanized steel. F Frames are 16-gage type 304 or 316 stainless steel.

RECOMMENDED USAGE

F-18 (1mm), FN-18 (1mm) or MU-18 (1mm) for 1-3/8" (35mm) or 1-3/4" (45mm) thick hollow core wood and 20-gage steel doors only.

F-16 (1.3mm), FN-16 (1.3mm), F-14 (1.7mm), FN-14 (1.7mm), F-12 (2.5mm) or MU-16 (1.3mm) for 1-3/4" (45mm) thick doors.

FE-16 (1.3mm) or FE-14 (1.7mm) for 1-3/4" (45mm) thick double egress doors.

Galvanized steel is recommended where atmospheric conditions require extra protection.

TYPICAL WALL CONDITIONS

F-SERIES

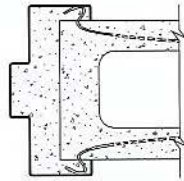

Wrap around block wall

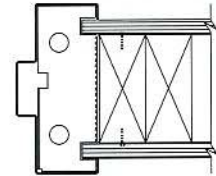

Wood Wall Stud

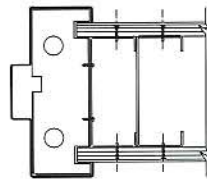

Closed Steel Stud Wall

FN-SERIES

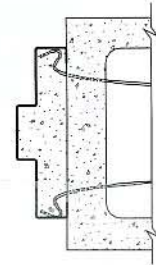

Butted Masonry

ANCHORS

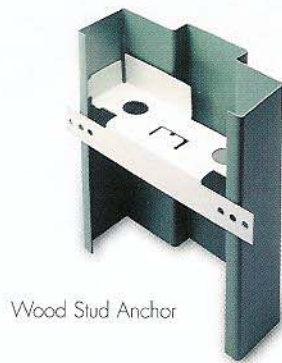

Wood Stud Anchor

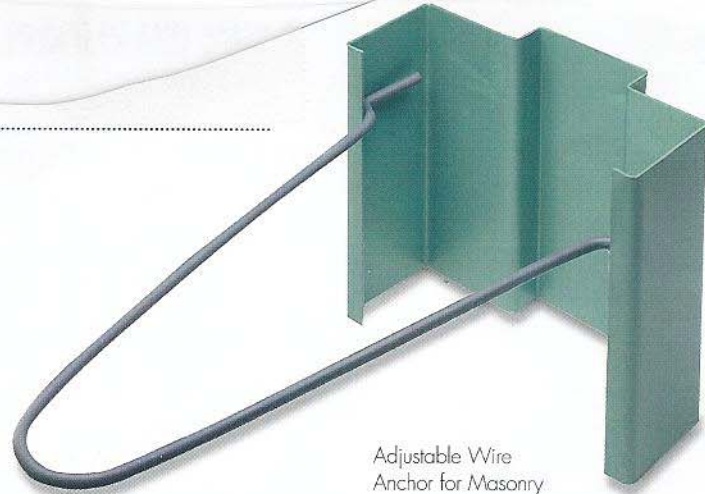

Adjustable Wire Anchor for Masonry

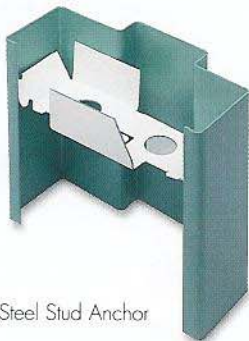

Closed Steel Stud Anchor

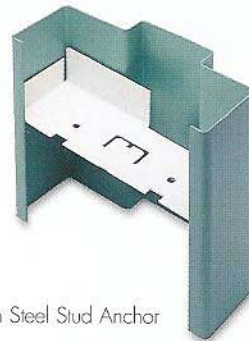

Open Steel Stud Anchor

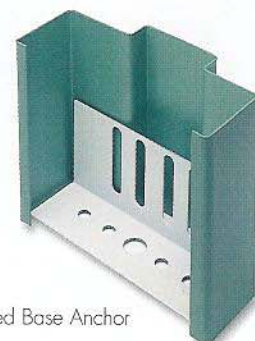

Adjusted Base Anchor